

T5S R 68W 2077-17

Revisions				
CODE	DATE	CASE	FROM	TO
001	08/07/61			A-2, F
002	04/17/69		R-2	LITTLETON
003	08/13/69		R-2	COLUMBINE VALLEY
004	11/13/69		R-2	COLUMBINE VALLEY
005	12/08/71	CVO1971-49	R-2	COLUMBINE VALLEY
006	08/15/73	CVO1973-59	R-2	COLUMBINE VALLEY
007	12/31/73	LO1973-16	R-2	LITTLETON
008	12/30/75	CVO1975-037	R-2	COLUMBINE VALLEY
009	07/16/75	CIV ADM		B2471-P380
009	06/03/77	CIV ADM		B2507-P149
010	03/04/80	LO1979-45	R-2	LITTLETON
011	12/17/87	LO1986-011	R-2	LITTLETON
012	12/01/92	LO1992-86	F	LITTLETON
013	02/05/96	LO1996-37	F.A-2	LITTLETON

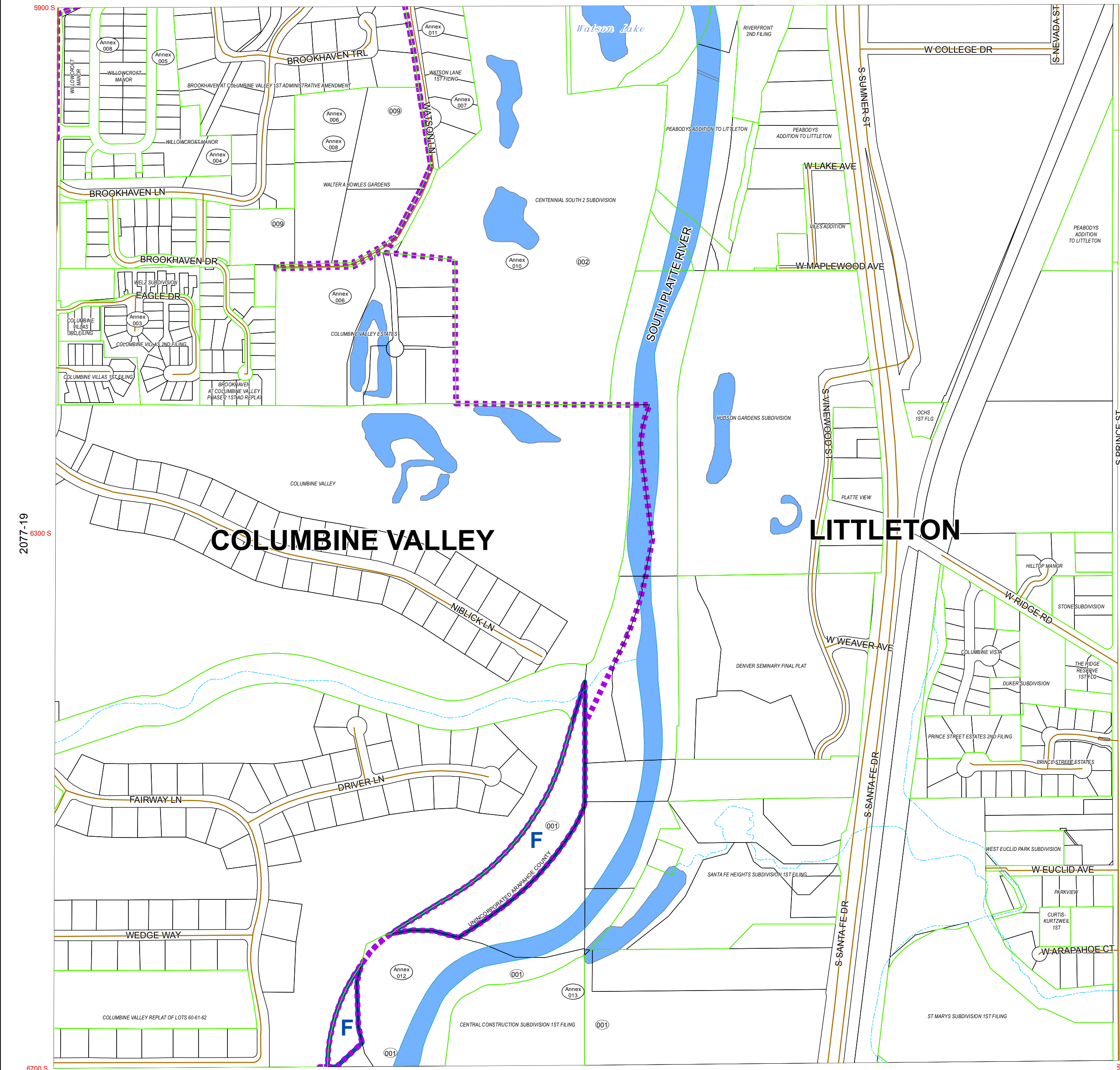

COLUMBINE VALLEY

LITTLETON

2077-19

2077-21

- Roads
- Subdivisions
- Parcels
- FDP/PDP
- Zoning
- Jurisdictions

2077-29

Code Sec
2077 20

Date Saved: 3/12/2014 4:21:42 PM

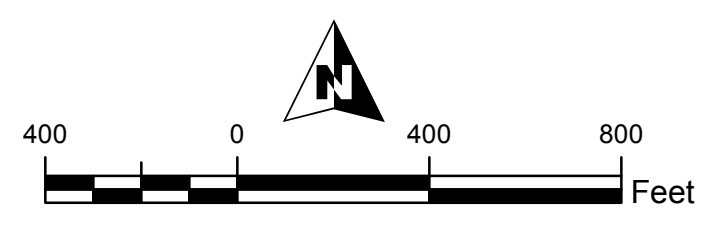

General Disclaimer:
Arapahoe County Makes No Representation Or Warranty As To The Accuracy Of This Base Map. And Assumes No Responsibility Or Liability To Any User. This Base Map Is Not A Legal Document . It Is Intended To Serve As An Aid In Graphic Repres entation Only.

T5S	R68W	R67W	R66W	R65W	R64W	R63W	R62W	R61W	R60W	R59W	R58W	R57W
	1971	1973	1975	1977	1979	1981	1983	1985	1987	1989	1991	1993
T4S	2077	2075	2073	2071	2069	2067	2065	2063	2061	2059	2057	2055