

CODE	DATE	CASE	FROM	TO
001	09/07/81			A-1
002	07/25/77	Z77-010	A-1	MU,F
003	07/27/81	Z81-018	A-1	MU,F
004	10/06/81	Z81-024	A-1	FDP
005	05/10/83	Z82-046	A-1	MU,F
006	05/16/83	Z82-022	A-1	MU,F
007	05/29/84	Z83-058	I-1, MU	MU,F
008	07/31/84	Z84-012	A-1, F	MU,F
009	01/27/86	Z85-036		MU
010	03/25/89	Z88-016		MU
011	07/27/89	Z89-025		MU
012	07/08/92	A91-010		MU
013	04/20/99	Z86-010	MU,F	MU,F
014	04/30/99	A98-037		PDP
015	09/07/99	L99-005		LE
016	10/12/99	P98-174		FDP
017	12/14/99	Z88-012	MU, F	MU, F
018	07/17/01	P00-084		FDP
019	02/06/01		CENTENNIAL INCORPORATION	
020	04/11/00	P99-117		FDP
021	06/22/02	P00-067		FDP
022	08/13/02	Z02-002		FDP
023	08/13/02	P02-009		FDP
024	11/19/02	Z00-021	MU, F	MU-MDP
025	01/17/03	A02-022		FDP
026	03/25/03	P02-028		FDP
027	02/25/04	A03-019		FDP
028	04/21/04	A03-018		FDP
029	06/01/04	L04-002		LE
030	08/09/04	A04-007		FDP
031	12/07/04	Z04-006		MU
032	01/04/05	L04-003		UBSR
033	01/07/05	A04-014		FDP
034	02/08/05	Z04-010		MU-MDP
035	06/14/05	P04-029		FDP
036	07/11/06	A06-004		UBSR
037	08/04/06	CO2006-O-04	A-1, F	CENTENNIAL
038	08/04/06	CO2006-O-05	A-1, F	CENTENNIAL
039	08/04/06	CO2006-O-06	MU	CENTENNIAL
040	11/03/06	A06-005		ASP
041	03/08/07	CO2006-O-21	MU	CENTENNIAL
042	06/19/07	TA07-005		FDP-TA
043	09/17/07	TA07-011		ASP-TA
044	03/10/08	A07-012		LE
045	05/14/08	Z08-003		MU-MDP
046	01/20/09	P07-025		FDP
047	03/03/09	A08-009		ASP
048	03/16/09	A08-008		ASP
049	03/28/11	TA11-001		FDP-TA
050	07/13/11	TA10-009		FDP-TA
051	10/03/11	A10-007		ASP
052	10/12/11	A11-001		ASP
053	01/31/12	TA11-011		ASP
054	03/26/12	TA12-003		ASP
055	10/01/13	Z13-002		MU-MDP
056	03/06/14	TA13-006		FDP-TA
057	03/06/14	TA13-007		FDP-TA
058	09/30/14	TA14-009		FDP-TA
059	11/24/15	CO2015-O-022	MU	CENTENNIAL
060	11/24/15	CO2015-O-028	MU	CENTENNIAL
061	06/14/16	L16-004		LE
062	01/28/17	TA17-001		FDP-TA
063	04/11/17	Z16-008		MU-MDP
064	05/16/17	U16-004		UBSR
065	06/19/17	A16-005		ASP
066	02/12/19	SDPZ18-002		MU-MDP
067	08/06/19	GDP19-001		MU-MDP
068	08/09/19	A17-004		ASP
069	12/17/20	AA20-026		ASP
070	12/22/21	ASP21-006		ASP
071	02/08/22	ASP21-007		ASP

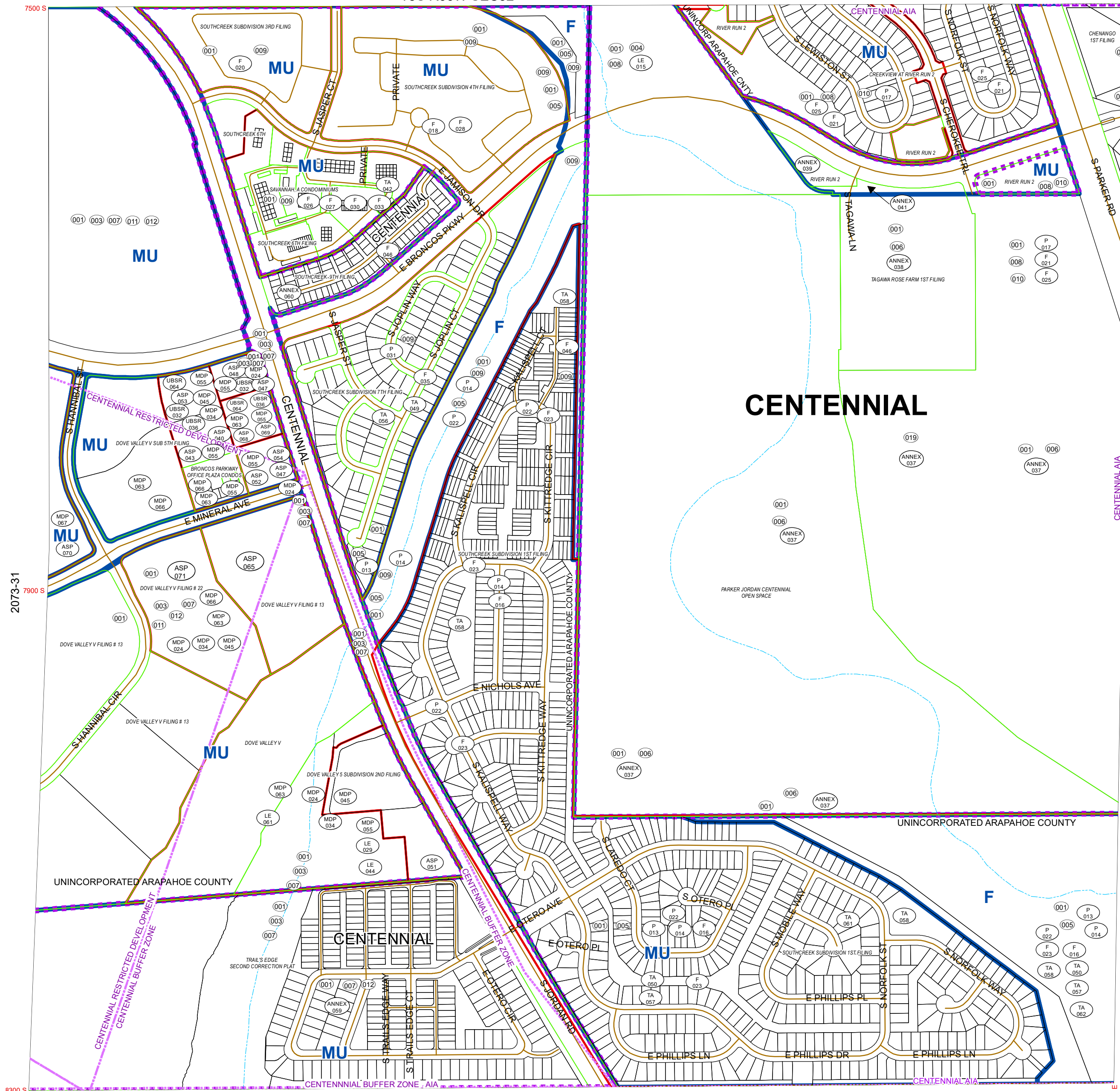

CENTENNIAL

2073-31

2073-33

8300 S 15300 E 16100 E Douglas County

- Roads
- Parcels
- Subdivisions
- Zoning Restrictions
- Zoning
- Jurisdictions
- Airport Influence Area

Code Sec
2073 32

Date Saved: 5/10/2022 2:51:57 PM

R68W	R67W	R66W	R65W	R64W	R63W	R62W	R61W	R60W	R59W	R58W	R57W		
1971	1973	1975	1977	1979	1981	1983	1985	1987	1989	1991	1993		
T5S													
		2077	2075	2073	2071	2069	2067	2065	2063	2061	2059	2057	2055

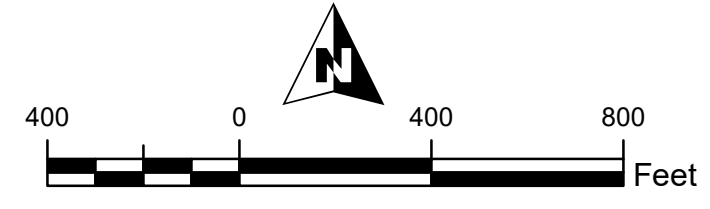

Path: G:\SIMHE\MAPPING\GIS\Projects\Zoning\ZoningmapsBySection\2073-32Zoning.mxd

General Disclaimer: Arapahoe County Makes No Representation Or Warranty As To The Accuracy Of This Base Map. And Assumes No Responsibility Or Liability To Any User. This Base Map Is Not A Legal Document. It Is Intended To Serve As An Aid In Graphic Representation Only.