

T5S R60W 1987  
T4S R60W

Revisions

CODE	DATE	CASE	FROM	TO
001	06/27/72	Zoning	Res	A-E, A-1
002	11-18-74	74-135	A-1	DEER TRAIL
003	06/25/90	U90-003		UBSR
004	06/25/90	U90-004		UBSR
005	04/22/97	U97-001		UBSR
006	11/23/98	98-119	A-E	DEER TRAIL
007	04/20/04	04-216	A-1	DEER TRAIL
008	06/25/08	08-2438	A-1	DEER TRAIL
009	06/25/08	08-244	A-1	DEER TRAIL
010	04/05/11	ASH10-001		ASI
011	08/02/11	L11-003		LE
012	08/05/16	16-254	A-1	DEER TRAIL
013	01/01/21	21-275	A-1, A-E	DEER TRAIL

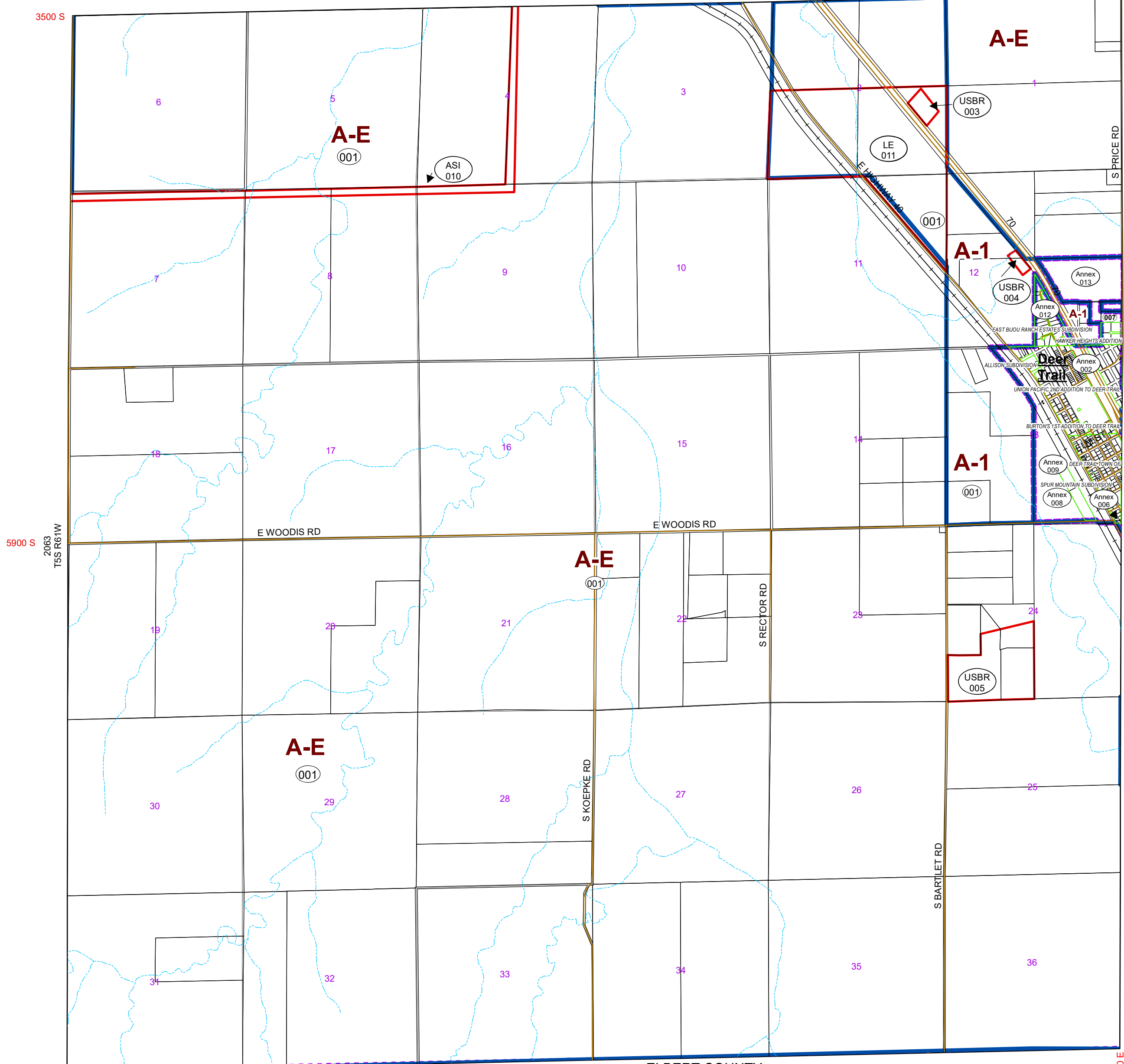

5900 S  
2063  
T5S R61W

2059  
T5S R59W

8300 S  
71300 E

80900 E

2245 ELBERT COUNTY  
T6S R60W

Code Sec  
2061 00

Date Saved: 2/5/2021 11:38:34 AM

General Disclaimer:  
Arapahoe County Makes No Representation Or Warranty As To The Accuracy Of This Base Map, And Assumes No Responsibility Or Liability To Any User. This Base Map Is Not A Legal Document. It Is Intended To Serve As An Aid In Graphic Representation Only.

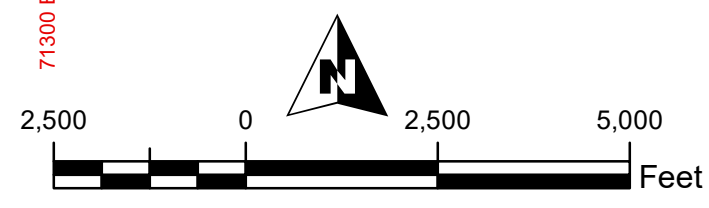

Path: G:\SIM\HEIMAPPING\GIS\Projects\Zoning\ZoningMapsByTwp\Twp2061\Zoning.mxd

- Railroads
- Roads
- ▭ Parcels
- ▭ Subdivisions
- ▭ Zoning Restrictions
- ▭ Zoning
- ▭ Jurisdictions

T5S	R68W	R67W	R66W	R65W	R64W	R63W	R62W	R61W	R60W	R59W	R58W	R57W
1971	1973	1975	1977	1979	1981	1983	1985	1987	1989	1991	1993	
2077	2075	2073	2071	2069	2067	2065	2063	2061	2059	2057	2055	