

T4S R66W SEC 11

1975-02

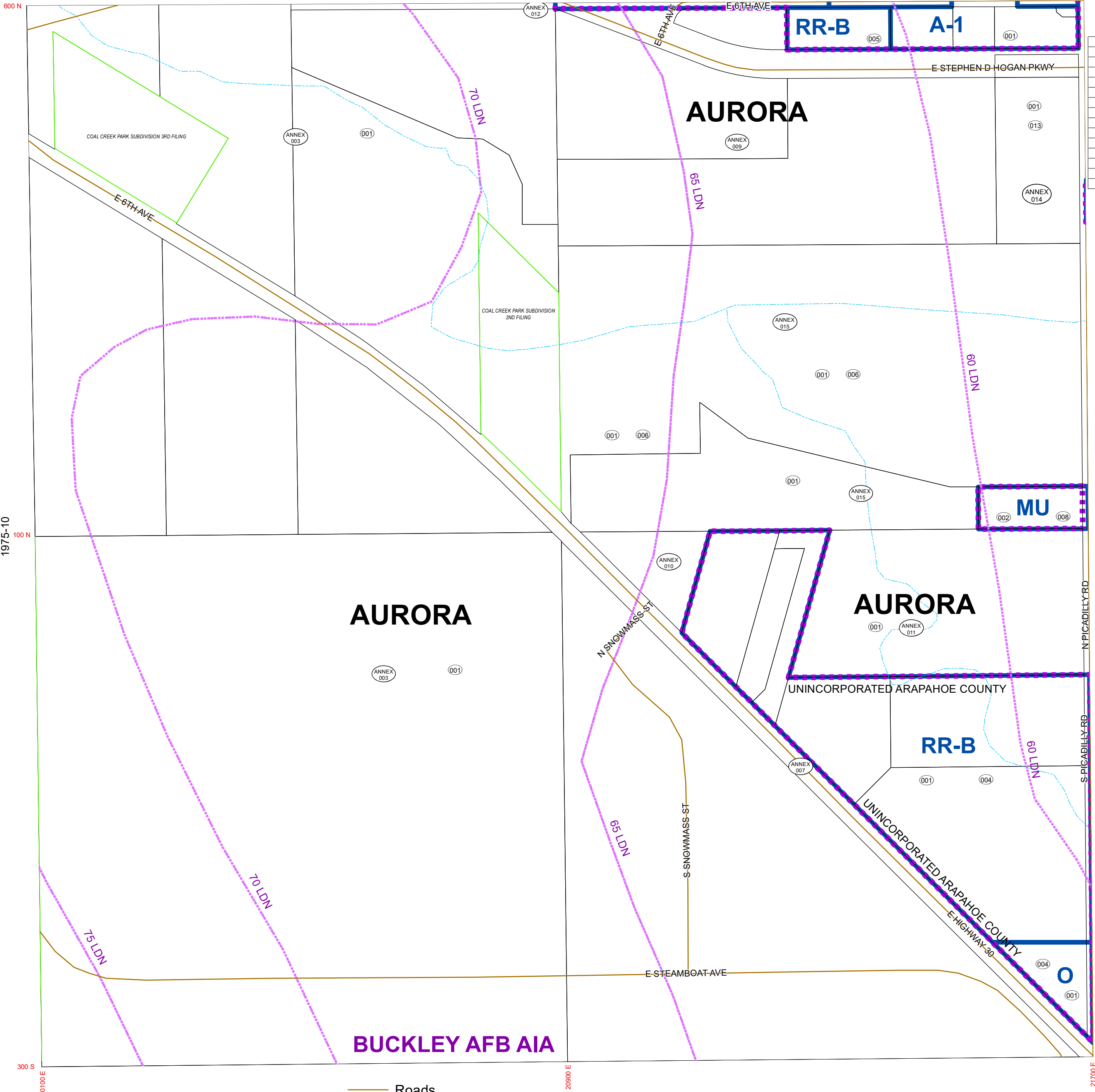

Revisions				
CODE	DATE	CASE	FROM	TO
001	08/07/61		A-1	A-1
002	10/28/69	Z69-034	A-1	R-A
003	05/22/73	AO 73-045	A-1	AURORA
004	06/10/74	Z73-043	A-1	R-A, O
005	11/15/77	Z77-026	A-1	R-A
006	08/27/79	Z79-022	A-1	F, O
007	09/10/85	AO 85-87	A-1, O, RA	AURORA
008	07/27/87	Z87-008	R-A	MU
009	03/12/91	AO 90-130	A-1	AURORA
010	04/17/95	AO 95-08	R-A	AURORA
011	12/27/00	AO 00-108	A-1	AURORA
012	09/20/03	AO 01-90	A-1	AURORA
013	10/07/03	Z02-003	A-1	R-A
014	09/05/20	AO 20-024	RR-B	AURORA
015	11/05/21	AO 21-026	A-1, O, F	AURORA

1975-10

1975-12

AURORA

AURORA

BUCKLEY AFB AIA

UNINCORPORATED ARAPAHOE COUNTY

RR-B

MU

Code Sec  
1975 11

1975-14

Date Saved: 11/23/2021 1:55:06 PM

General Disclaimer:  
 Arapahoe County Makes No Representation Or Warranty As To The Accuracy Of This Base Map, And Assumes No Responsibility Or Liability To Any User. This Base Map Is Not A Legal Document . It Is Intended To Serve As An Aid In Graphic Representation Only.

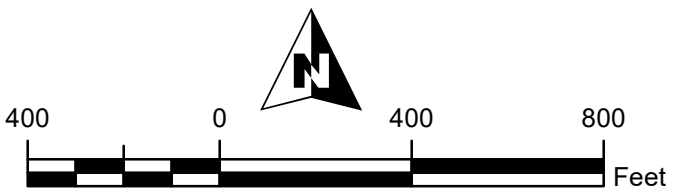

- Roads
- Parcels
- Subdivisions
- Zoning Restrictions
- Zoning
- Airport Influence Area
- Jurisdictions

	R66W	R67W	R66W	R65W	R64W	R63W	R62W	R61W	R60W	R59W	R58W	R57W
T4S	1971	1973	1975	1977	1979	1981	1983	1985	1987	1989	1991	1993
T5S	2077	2075	2073	2071	2069	2067	2065	2063	2061	2059	2057	2055