

R65W T4S SEC 03

ADAMS COUNTY

		Revisions		
Code	Date	Case	From	To
001	08/07/81			A-1,R,M
002	08/26/89	Z99-030	A-1	B-5
003	04/21/87	AO 1986-196	A-1	AURORA
004	04/21/87	AO 1986-197	A-1	AURORA
005	01/06/94	Z01-010	MU,A-1,F	MU,F
006	04/02/05	A04-010		PDP
007	06/17/14	U14-001		UBSR
008	02/11/15	TA14-012		UBSR-TA
009	02/03/15	L14-002		LE
010	11/25/15	Z15-003	MU,F	MU,F
011	11/21/17	L17-007		LE
012	01/23/18	Z17-006	MU,F	PDP
013	06/12/19	AA19-004		UBSR-AA
014	07/30/19	AA19-005		UBSR-AA
015	09/30/19	AA19-012		LE
016	10/27/20	GDP18-007	MU,F	PUD
017	12/15/20	SDP20-007		SSDP
018	08/02/21	AA21-010		SSOP AMENDMENT
019	08/18/21	AA21-011		UBSR-AA
020	09/28/21	ASP20-010		ASP

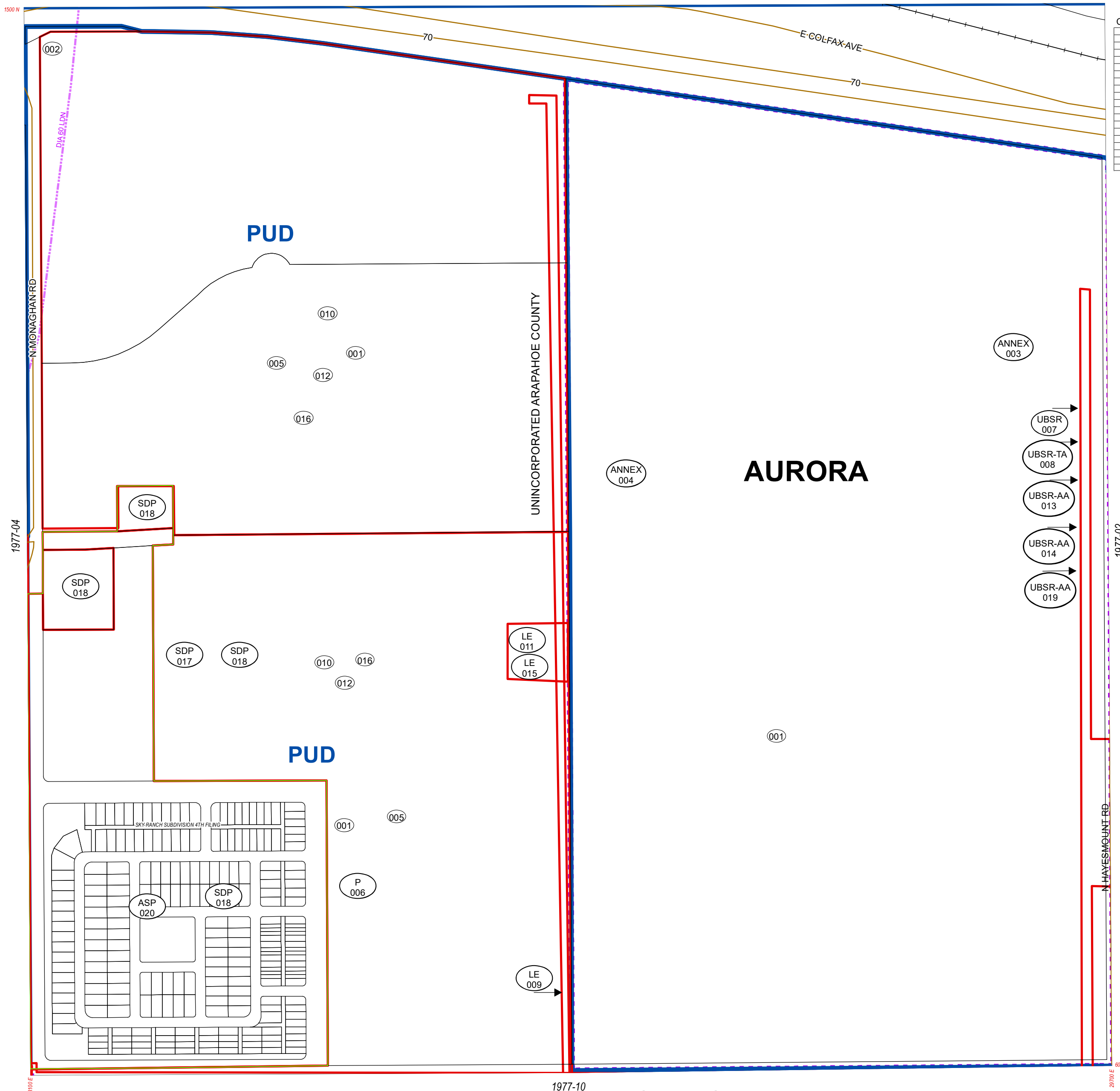

AURORA

UNINCORPORATED ARAPAHOE COUNTY

PUD

PUD

ANNEX 004

ANNEX 003

UBSR 007

UBSR-TA 008

UBSR-AA 013

UBSR-AA 014

UBSR-AA 019

SDP 018

SDP 018

SDP 017

SDP 018

010

016

012

LE 011

LE 015

ASP 020

SDP 018

001

005

P 006

LE 009

1977-10

Code Sec
1977 03

Date Saved: 9/29/2021 5:19:09 PM

R68W	R67W	R66W	R65W	R64W	R63W	R62W	R61W	R60W	R59W	R58W	R57W
1971	1973	1975	1977	1979	1981	1983	1985	1987	1989	1991	1993
T4S	2077	2075	2073	2071	2069	2067	2065	2063	2061	2059	2057
T5S											

- Railroads
- Roads
- Parcels
- Zoning Restrictions
- Zoning
- Airport Influence Area
- Jurisdictions

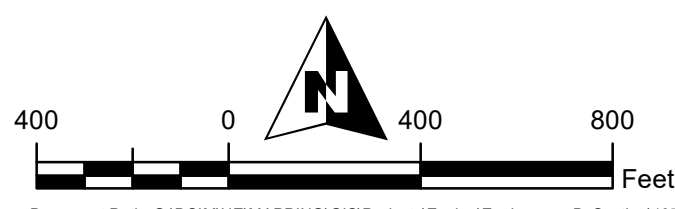

Document Path: G:\DSIMHEWAPPING\GIS\Projects\Zoning\ZoningmapsBySection\1977-03\Zoning.mxd

General Disclaimer:
Arapahoe County Makes No Representation Or Warranty As To The Accuracy Of This Base Map, And Assumes No Responsibility Or Liability To Any User. This Base Map Is Not A Legal Document. It Is Intended To Serve As An Aid In Graphic Representation Only.